

OLMOS  
PARK

# OLMOS PARK SHOPPING CENTER

Radom  
CAPITAL

# Property Information

## Olmos

### CITY

San Antonio

### NEIGHBORHOOD

Olmos Park

### TYPE

Retail

### PARKING

110  
4.3 per 1,000

### AVAILABLE

Suite 103

### SIZE

1,670 SF



Positioned in the heart of one of San Antonio's most vibrant trade corridors, Olmos Park Shopping Center is a distinguished retail property located on nearly one acre along Hildebrand and McCullough Avenue, the area's signature thoroughfare. With generous parking, and high visibility to both daily commuters and nearby residents, the property offers an ideal setting for retail, service, or lifestyle tenants seeking a well-located space in a thriving, centrally positioned district.

Olmos Park offers a rare blend of elegance and accessibility: residents enjoy the tranquility of a tree-lined, small-town enclave while remaining just minutes from downtown San Antonio, Alamo Heights, the Pearl District, and other major cultural and commercial destinations. With McCullough Avenue serving as a direct connection to the city's urban core, the property stands at the intersection of local charm and regional reach—making it a prime destination for both businesses and the community they serve.



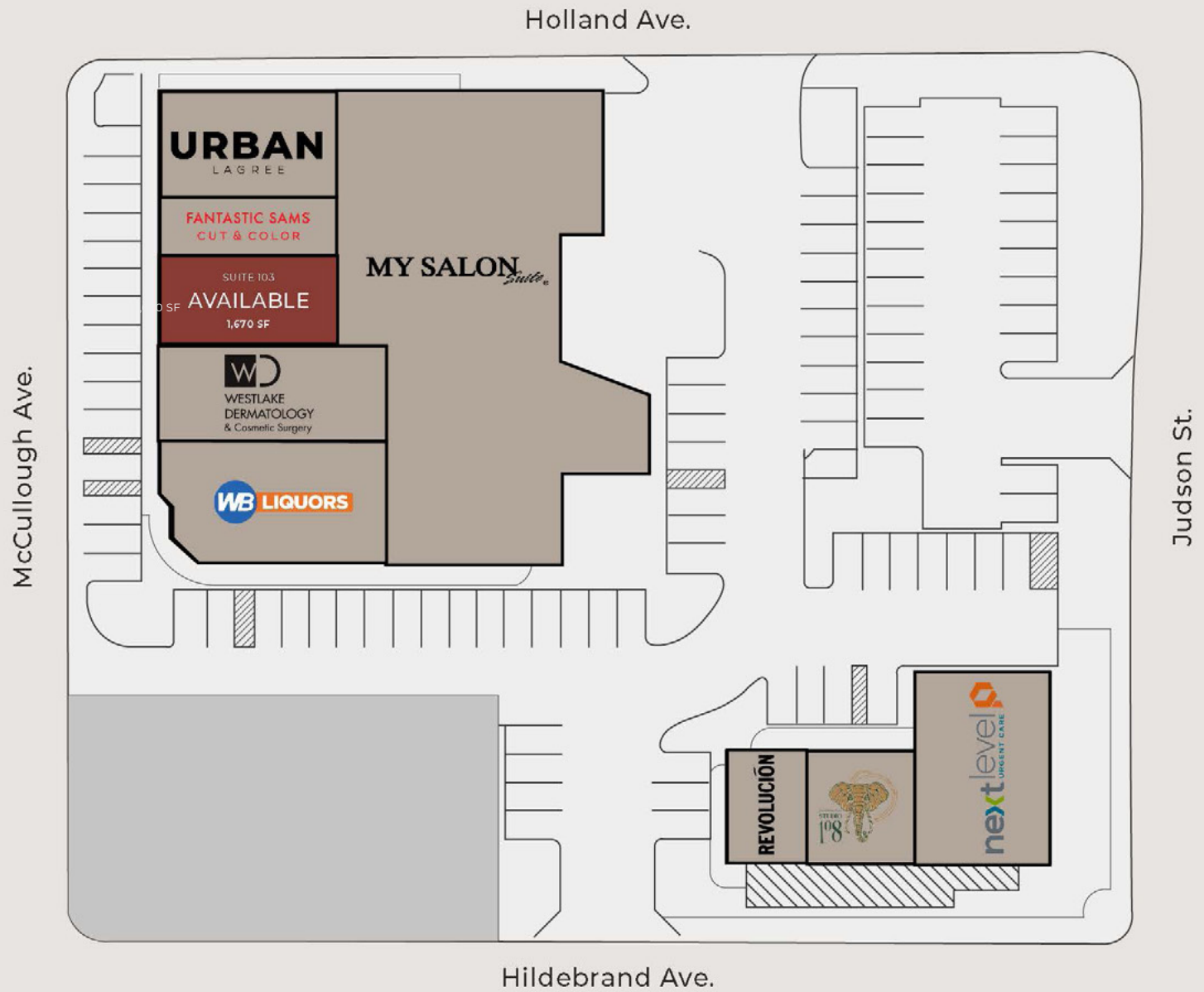

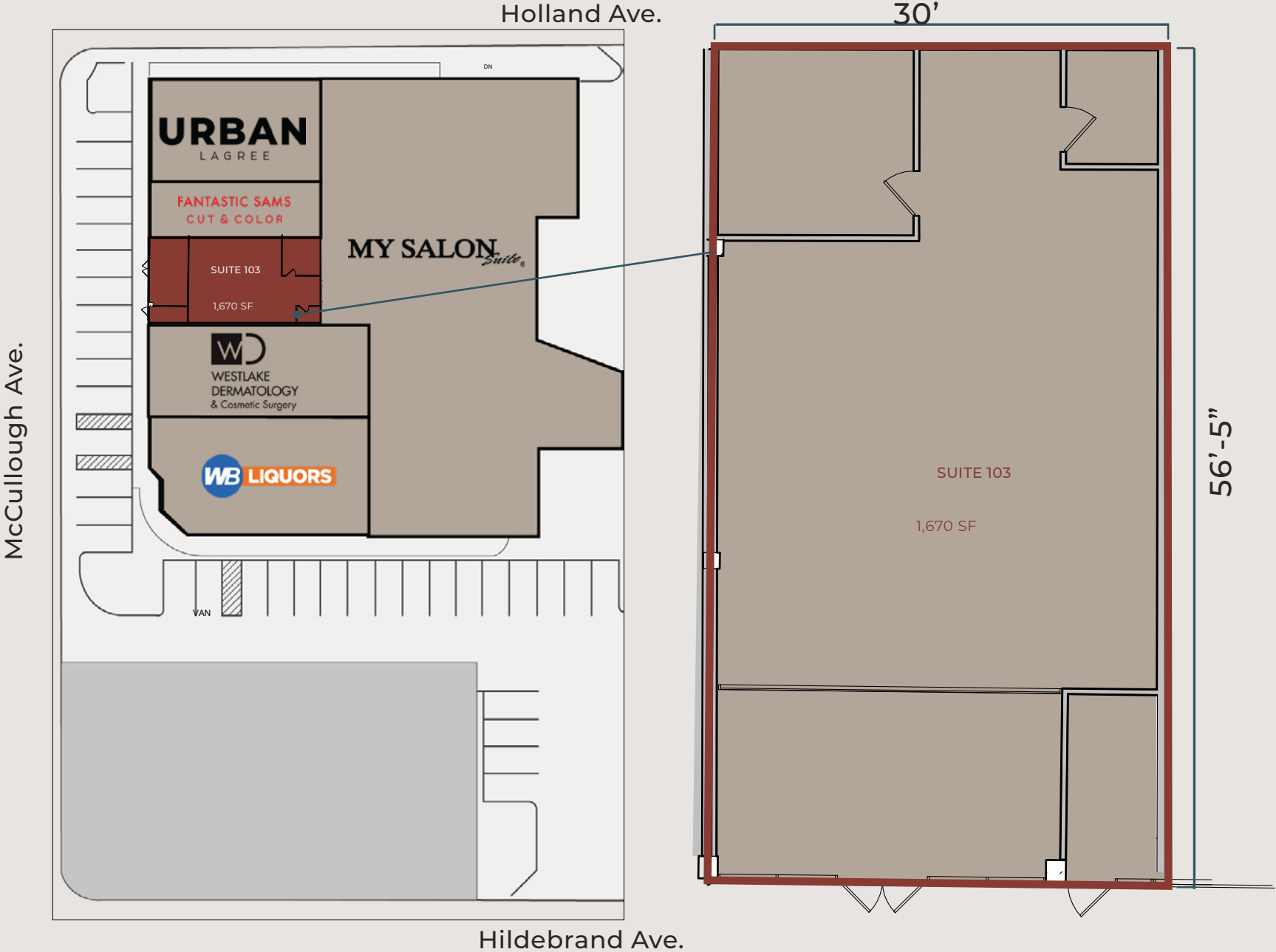

# Location

# Demographics



# Developer



Radom Capital is an award-winning, diversified real estate investment, development and management firm based down the road in Houston, Texas. We aspire to collaborate community, culture and commerce in all of our projects.

We are real estate dreamers.

The logo for SHOP COS. is centered on a dark teal background. It consists of a red rectangular box containing the word "SHOP" in a white, serif, all-caps font. To the right of "SHOP" is the word "COS." in a smaller, white, sans-serif, all-caps font, with a horizontal line underneath it. Two horizontal red lines extend from the left and right sides of the red box across the width of the page.

SHOP<sup>COS.</sup>

**Zach Fregosi**

zach@shopcompanies.com  
210-985-7116

**Scott Petersen**

scott@shopcompanies.com  
210-985-7646